

HDS1 Air Conditioning Disconnects



101001011100101010010100101010101
 1001010100010101011001010101010101
 01010101010101010101010101010100100100

Product overview

The Most Widely Used Application for Air Conditioning Disconnects is for Residential and Light Commercial Air Conditioning Units. Air Conditioning Disconnects are also found in use with Heat Pumps, Swimming Pools, Spas, Whirlpools and Pump Houses and Required for Servicing Electric Water Heaters.

Features & benefits

- ◇ Metallic and non-metallic options are NEMA 3R rated outdoor enclosures
- ◇ Easy-to-remove high-strength protective shield
- ◇ Easy-to-remove front cover
- ◇ Copper-rated line and load lugs
- ◇ Ample wiring space for mounting with a stud gun
- ◇ Padlock-able door provision for safety and reduction of tampering
- ◇ Factory-installed tamper resistant/weather-resistant ground fault receptacles

Product certification



UL

UL 1429



RoHS

RoHS Compliant

Specification

Air Conditioning Disconnects

Cat. No.	Description	Main Ampere Rating	HP Rating		Wire Size(AWG) & Torque Cu/AL	
			120V	240V	LINE/LOAD	GROUND
HDS1-30A	Enclosed Fused ACD	30AMP 240V 1 PHASE 2-Pole 3-WIRE	STD. 0.5 MAX. 2	STD. 1.5 MAX. 3	#14-10 35LB-IN #8 40LB-IN #6-4 45LB-IN #2 50LB-IN	#14-10 25LB-IN #8 40LB-IN
HDS1-60A	Enclosed Fused ACD	60AMP 240V 1 PHASE 2-Pole 3-WIRE	STD. 1.5 MAX. 3	STD. 3 MAX. 10	#14-10 35LB-IN #8 40LB-IN #6-4 45LB-IN #2 50LB-IN	#14-10 25LB-IN #8 40LB-IN
HDS1-60AN	Enclosed Non-Fused ACD	60AMP 240V 1 PHASE 2-Pole 3-WIRE	-	STD. 3 MAX. 10	#14-10 35LB-IN #8 40LB-IN #6-4 45LB-IN #2 50LB-IN	#14-10 25LB-IN #8 40LB-IN

Dimensions

HDS1-30A, HDS1-60AN

inch[mm]

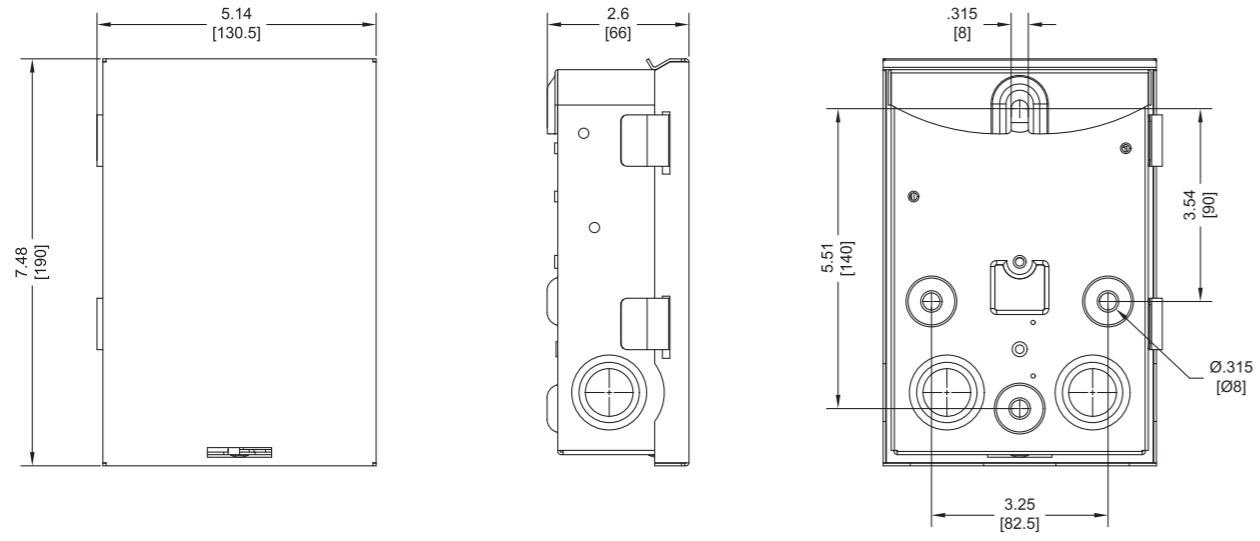

HDS1-60A

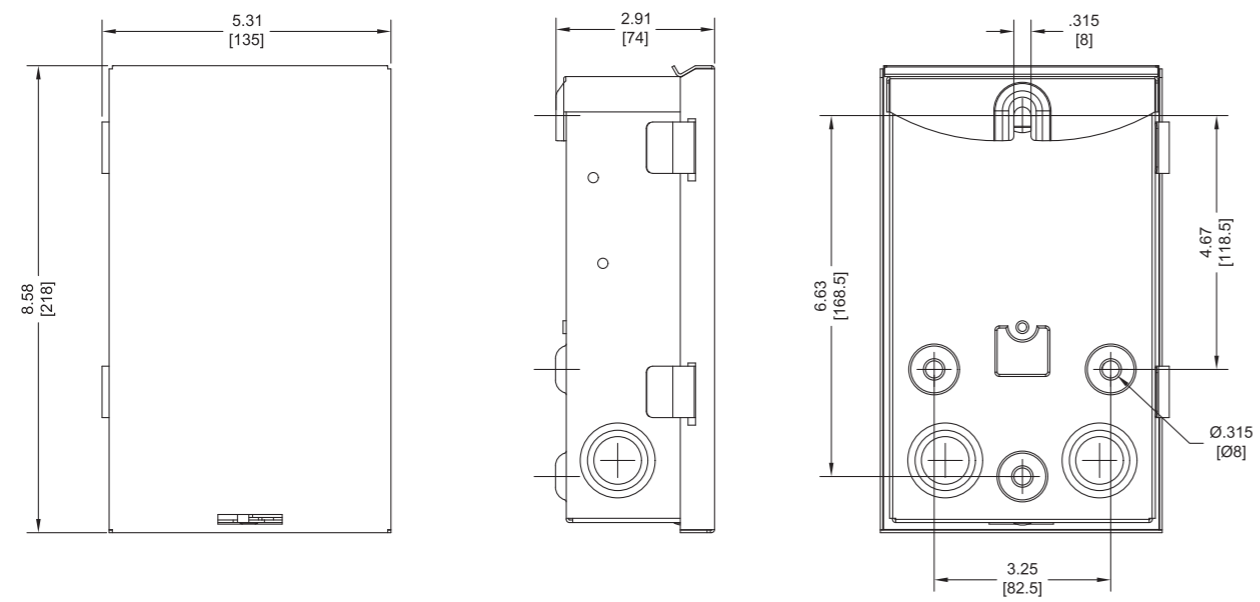

HDS1 Air Conditioning Disconnects